

PREMIUM RETRACTABLE

INSTRUCTION SHEET

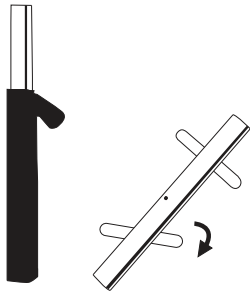

- 1** Remove unit from bag and turn stabilizing feet to a 90° angle.

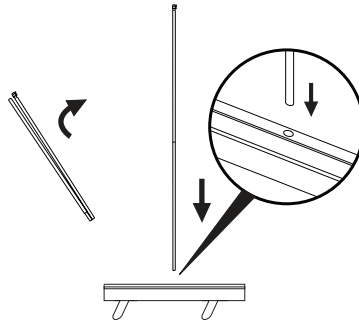

- 2** Unfold the telescopic pole and insert the round end into hole in the base.

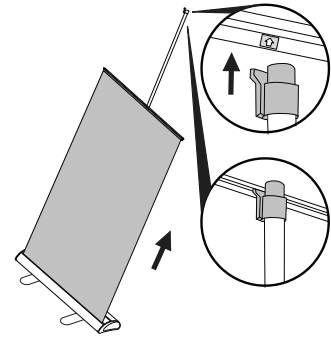

- 3** Attach the top rail of the banner to the plastic holder at the top of the pole. Lean back stand if the top of the pole is too high.

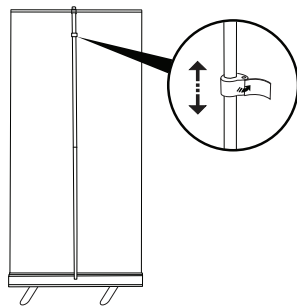

- 4** Open the lever lock and extend the upper section of the pole to the desired height. Close the lever lock to secure.

Standard Graphic Height 80"
Short Graphic Height 33"
Tall Graphic Height 88"



How to attach or replace graphics.

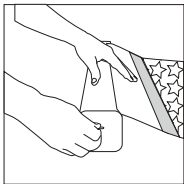

- 1** Pull graphic out until the leader is exposed. Insert locking pin to disable the roller.*

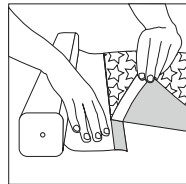

- 2** Remove graphic and replace.

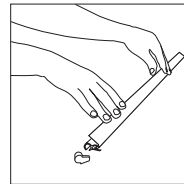

- 3** Remove end caps and pull open the snap lock profile.

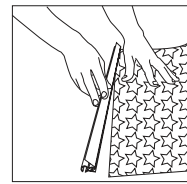

- 4** Once the snap-lock Profile is open insert top portion of graphic into profile.*

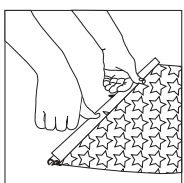

- 5** Apply even pressure to the snap-lock profile to lock graphic into place. Replace end caps.



- 6** Grip image and unit securely and remove locking pin. Slowly guide image back into unit.

*** CAUTION:** Do not remove the locking pin until the profile is attached to the graphic and the graphic is attached to the leader.