

# WALL & TABLE ALIGNMENT

FOR 2/3 POST FOOT

Overlapped walls with table on right wall.

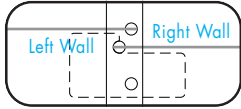

(2 or 3 Post Left Center Foot)

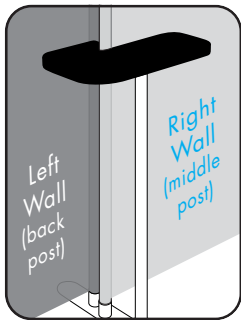

- 1 Mount left wall on back post.
- 2 Mount right wall on middle post.
- 3 Mount table on front post.

Overlapped walls with table on left wall.

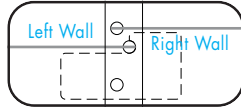

(2 or 3 Post Right Center Foot)

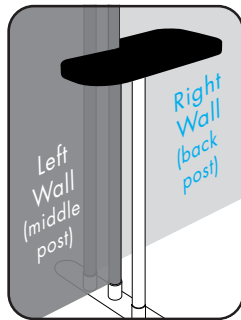

- 1 Mount right wall on back post.
- 2 Mount left wall on middle post.
- 3 Mount table on front post.

Single wall with table on left.

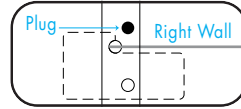

(2 or 3 Post Left Center Foot)

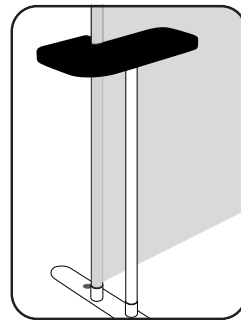

- 1 Mount right wall on middle post.
- 2 Mount table on front post.
- 3 Remove and plug back post if desired.

Single wall with table on right.

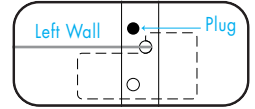

(2 or 3 Post Right Center Foot)

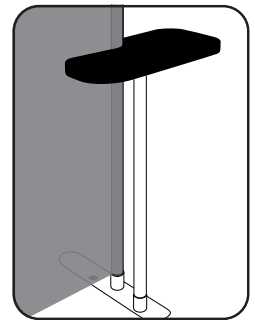

- 1 Mount left wall on middle post.
- 2 Mount table on front post.
- 3 Remove and plug back post if desired.

## 2 Walls — No Table

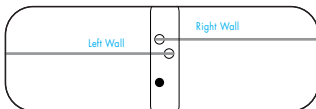

(2 or 3 Post Right Center Foot)

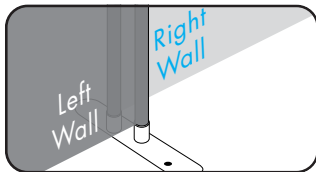

Left Wall Front

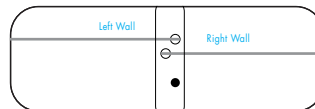

(2 or 3 Post Left Center Foot)

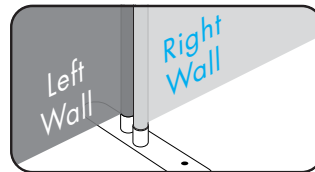

Right Wall Front

## How to remove post and replace with plug:

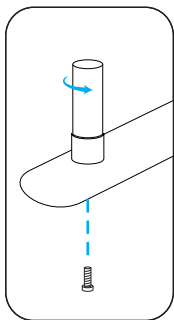

- 1 Using hand twist off post.  
Note: If post is too tight, use allen wrench to remove screw/post.

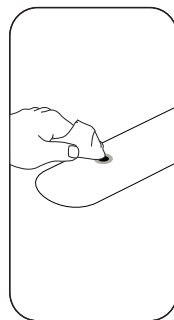

- 2 Using included cloth, wipe away any remaining dirt/dust.

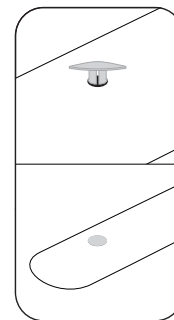

- 3 Press plug firmly into hole.